

NOTES:

- 1 MATERIAL: THERMOPLASTIC GLASS-FILLED, UL94V-0 HOUSING; PHOSPHOR BRONZE CONTACTS; DIMENSION OF MATING AND TERMINATION
- 2 DIMENSION OF MATING AND TERMINATION

LENGTH / WIDTH x THICKNESS	TERMINATION	LENGTH
A : 5.3 / 0.4 - 0.50 x 0.4 - 0.36		3.7
B : 6.8 / 0.4 - 0.50 x 0.4 - 0.36		3.7
C : 8.3 / 0.4 - 0.50 x 0.4 - 0.36		3.7
- 3 FINISH: 30u" (0.75m) GOLD PLATING ON CONTACT AREA, TIN-PLATED ON TAIL, UNDER PLATING NICKEL ALL OVER
- 4 MARKING: SULLINS

PART NUMBER
MFG CODE/BATCH NUMBER
ON THE APPROXIMATE AREA AS DRAWING

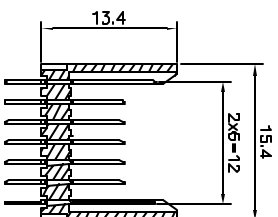

CONTACT DIMENSION

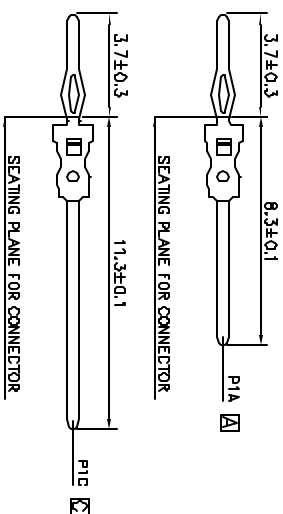

DESCRIPTION : 2.0mm MALE, TYPE B25

PRODUCT

No.1	2B25M76P1001-1-H			
No.2				
No.3		m/m	QWIF095A	
No.4				TA0107

Sullins Electronics Corp